

MEMORANDUM

DATE: October 14, 2022
TO: Baldwin Public Library Board of Directors
FROM: Rebekah Craft, Library Director
SUBJECT: Updates to Café plan

CAFÉ PLAN UPDATE

Following the Building Committee on September 22, 2022, MCD made adjustments to the café plan presented at the September 19 Board meeting to accommodate Board member requests.

The orientation of the public restroom and café counter was shifted. This new layout allows the new café counter to include a vending machine for cold drinks and snacks, a coffee vending machine, a sink, an in-cabinet refrigerator, and an under mounted trash can. The backsplash will be fully washable. There will be a sign above the café counter saying “coffee” that can be read from the front entrance. The new orientation of the café allows the focus of the café to be on the tables, the artwork, and the main entrance to the library; no vending machines are visible from the sidewalk.

This design meets the following objectives:

- Maintains a clear walkway from the front vestibule out to the Nanawall doors on the east side of the café.
- Ensures that any furniture placed in front of the ramp does not obscure the ramp; ideally nothing placed in front of the ramp should be taller than the ramp.
- Maintains sightlines to the artwork installation above the ramp and preserves the original Birkerts spandrel glass windows.
- Provides ample seating for library users.

Earlier this year, we surveyed staff and Board members about potential uses of the café and outdoor area. We want to make sure that our café can accommodate the following uses:

- Host an after-hours indoor/outdoor fundraiser in the spring/summer/fall with entertainment (speaker/author/band), food tables, bartender, live music
- Use it for messier programs - like cooking demos, gardening demos, craft demos
- Host an after-hours author talk outside and use the cafe inside for drinks/refreshments
- Consider renting the space for private events hosted by residents who have BPL library cards

We would be able to accommodate the above uses for the café with the new recessed countertop by using the built in café alcove and also pulling 2-3 tall café tables close to the café alcove to use as additional, flexible counterspace for a bartender, food table, or cooking demo. Not having a permanent fixture that cuts into the middle of the café walkway greatly helps to maximize flexibility.

Renderings of the café space and an updated floor plan are shown below.

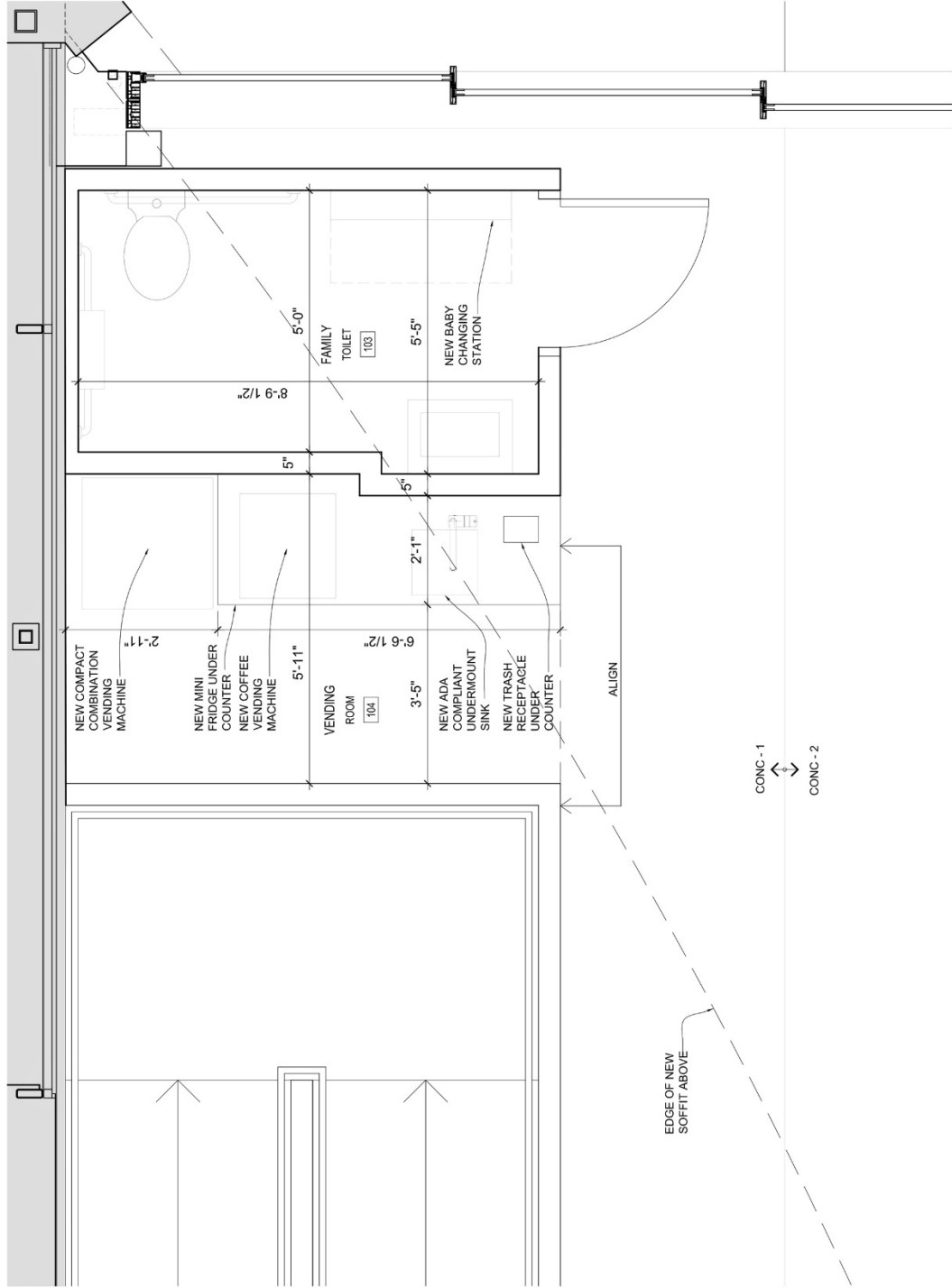

ADDITION & RENOVATION FOR:
**BALDWIN
 PUBLIC
 LIBRARY**
 300 W. MERRILL ST.
 BIRMINGHAM, MI



ARCHITECTURE | PLANNING
 33610 Grand River
 Farmington, Michigan 48335
 248-374-0001
 www.mcdarchitects.com

SK-09302022-1

1 SK-1 VENDING & TOILET ROOM PLAN
 SK--09302022-1 1/2" = 1'-0"

Café view from east



Café view from west



Café view interior



SUGGESTED BOARD ACTION

To make a motion to adopt the proposed design, dated September 30, 2022, for the vending café in the Phase 3 renovation.